



Hydraulic motor series m

Data sheet

Md_{cont. max} 1'640 Nm
Md_{int. max} 2'380 Nm

8

english_20120823/Wa

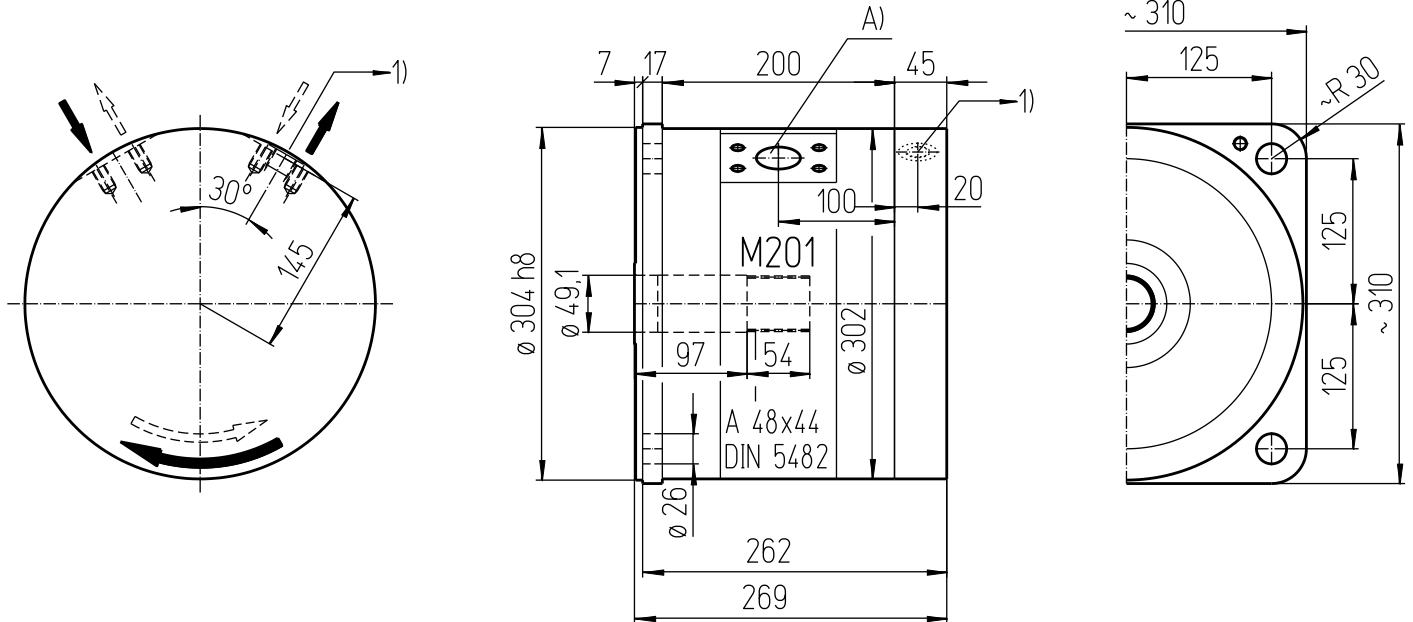

Important instructions:

Observe our installation and operating instructions
 Before start up fill hydraulic motor with oil
 Oil filling: ca. 3,5 Liter
 Weight: ca. 117,3 kg
 Fastening screw: M24 - 12.9 // Tightening torque: 1220 Nm

Oil connections:

A) SAE 1 1/2" 210bar ISO 6162-2 DN25 42 MPa
 1) Drain G1/2

Possible special design:

- Hollow shaft
- Second shaft extension
- Adaptation and mounting of brakes, non-return devices, tachometer sensor

Technical data:

Denomination		Output torque		Torque constant	Output speed		Displacement	Mass moment of inertia	Oil connections
Type	EDV-No.	Nm		Nm/bar	min ⁻¹		Liter / rev.	kgm ²	
		cont. 145 bar	int. 210 bar		cont.	int.	cm ³		
M201	8	1640	2380	11,3	600	750	750	0,043	radial